



RACE LINE

The best choice for all racing yachts is the race line. The body is made of 7075-T651 hardcoated aluminium fully machined for extreme weight saving. These valves have been tested on AC, STP 65 and TP52 yachts and ocean race boats.

As for other Cariboni's valves, each valve is able to control a single acting cylinder with a 3 position control knob (pump-hold-release).

All Race line valves can run over 700 bar (10.000 PSI) working pressure and up to 8 lpm maximum oil flow; they can be fitted on linear or crossed standard arrangement with lightweight manifold.

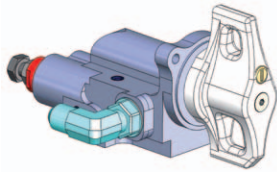
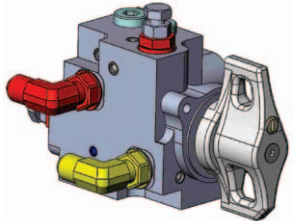

Luna Rossa catamaran
manual valves, pumps and titanium rams.

VALVE TYPE	MAIN FEATURES	APPLICATION
CM_VSBC_A_12254 	Max working pressure: 700 bar (10.000PSI) Weight: 0,311kg (0,685lbs) Max oil flow: 8lpm Hard coated aluminium Hold-pump-release positions Relief pressure valve incorporated Flow release control 7/16" JIC UNF 37° stainless steel fitting*	Single valve with max pressure valve It can be used to run every kind of single acting cylinder on race sailing yachts.
CM_VD_A_14744 	Max working pressure: 700 bar (10.000 PSI) Weight: 0,560kg (1,234lbs) Max oil flow: 8lpm Hard coated aluminium Hold – pump A – pump B positions Relief pressure valve incorporated Flow release control 7/16" JIC UNF 37° stainless steel fittings*	Double valve with max pressure valves Double acting cylinders Lifting keel manual back-up Canting keel manual back-up

* Custom fittings available on request (1/4" BSPP – 9/16" JIC UNF 37° - 3/8" BSPP) **also in titanium alloy**

All valves types can be placed on linear or crossed lightweight aluminium manifold

MAIN DIMENSIONS

Single valve model with max pressure valve

Double valve model with max pressure valves

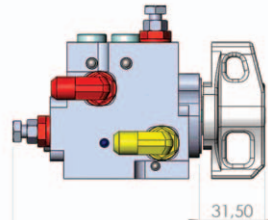
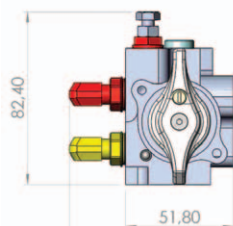
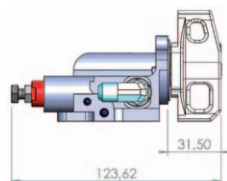
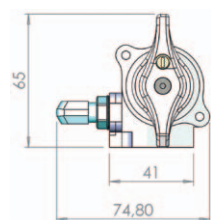

BAGOLIN LINE

After the presentation at the 2010 Mets Exhibition, several tests confirmed the efficiency of this new generation of manual race valves, the Bagolin valves.

The valves can be assembled in different ways: one/two/three in line or crossed, until 5 positions. With the new manual knob, the release speed can be easily controlled.

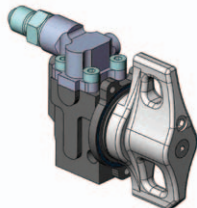
VALVE TYPE	MAIN FEATURES	APPLICATION
CM_VS_A_13081 	Max working pressure: 700 bar (10.000 PSI) Weight: 0,174kg (0,384lbs) Max oil flow: 6lpm Hard coated aluminium Hold – pump – release positions Manual release control 7/16" JIC UNF 37° stainless steel fittings*	It can be used to run every kind of single acting cylinder on race sailing yachts

* Custom fitting available on request also made of titanium alloy

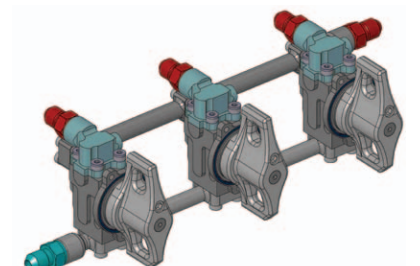
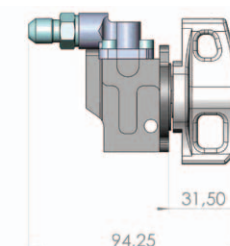
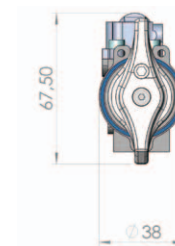

RACE LINE VALVES PANELS & ARRANGEMENTS

Single and double valves can be placed on lightweight ergal 7075-T651 manifold for linear or crossed arrangements. Each arrangement is supplied with stainless steel fittings: aluminum or titanium fittings available on request.

Race line panels are designed to have pressurized suction and return lines and can be equipped with electric power pump back-up for maximum performances.

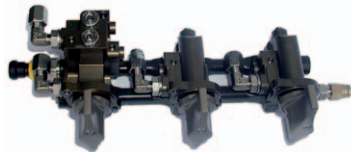
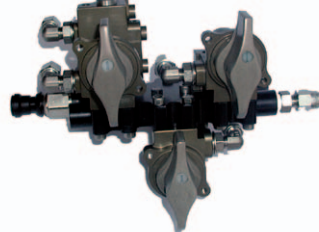
TYPE	NUMBER OF VALVES	WEIGHT
LINEAR ARRANGEMENT 	From 1 to 5 single or double valve as preferred, with or without max pressure valve	Weigh for position (a valve for each, single or double): 1 pos: 0,086 kg (0,19 lbs) 2 pos: 0,187 kg (0,41 lbs) 3 pos: 0,283 kg (0,62 lbs) 4 pos: 0,379 kg (0,84 lbs) 5 pos: 0,475 kg (1,05 lbs)
CROSSED ARRANGEMENT 	From 1 to 8 single or double valve as preferred, with or without max pressure valve	Weigh for position (a valve for each, single or double): 1 pos: 0,086 kg (0,19 lbs) 2 pos: 0,187 kg (0,41 lbs) 3 pos: 0,270 kg (0,6 lbs) 4 pos: 0,370 kg (0,82 lbs) 5 pos: 0,440 kg (0,97lbs) 6 pos: 0,539 kg (1,19 lbs) 7 pos: 0,610 kg (1,34 lbs) 8 pos: 0,710 kg (1,57 lbs)